

Clamp-On Frame Windows - Aluminum

Multi-Lites, Dropdowns, Returns and More

- **Clamp-On Frame with Shelf and Deal Tray**
Designed for Arenas, Stadiums, Theatres, Etc.

Multi-Lite Clamp-On Frame Windows are commonly used for installations with multiple workstations, such as those found in walk-up ticket offices in arenas, stadiums, movie theatres and convenience stores. Window options include speak-thrus, deal trays, shelves, dropdowns, returns and more. Clamp-On Frame is designed for installation into walls from 5" to 8-1/2" thick. An overhang or awning is recommended if used in an exterior application.

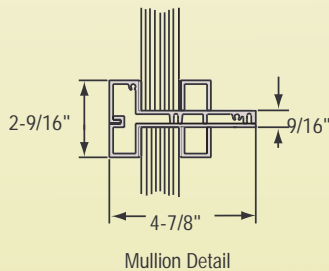
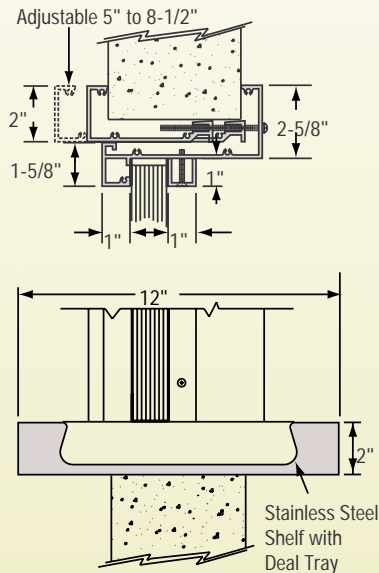

PROTECTION LEVEL



SPECIFICATIONS:

Materials: Frame - .125" Thick Extruded 6063-T5 Aluminum Alloy;
 Glazing - 1/4" Glass; 1-5/16" Level 1 Glass; 1-1/4" Level 1 Acrylic; 3/4" Level 1 Lexgard;
 1-5/8" Level 2 Glass; 1-7/8" Level 3 Glass; 1-1/4" Level 3 Lexgard; Shelf - Stainless Steel
Finishes: Frame - Satin Anodized, Duranodic Bronze, RAL Powder Paint Colors or Custom Kynar Paint Colors; Shelf - Brushed Stainless Steel
Deal Tray: Level 1 or Level 3 Protection
Instructions Included

SERIES: COSWA, COSWDU, COSWP

OVERALL SIZE (W x H)

Must Be Specified

