

Clear Package Receiver



Left Hand Model
(Customer's Side)

- Bullet Resistant – Available in Level 1 or Level 3 Protection
- Contents are in Full-View to Clerk without Opening Inner Door

The Clear Package Receiver is designed for interior use only. Satin finish aluminum extrusions are used to fasten the sides and bottom together. Bottom is constructed of plywood and bullet resistant fiberglass covered with plastic laminate. A special interlocking mechanism allows only one door to open at a time. Closer furnished on customer side door. Contents can be clearly viewed from the top and all four sides. Handing is determined by hinge placement on customer's side. Inside Dimensions: 13-5/16" wide x 12-1/2" deep x 13-3/8" high.



Right Hand Model
(Customer's Side)



CAT. NO.	PROTECTION LEVEL	HANDING	WIDTH*	DEPTH*	HEIGHT*
CPR1	1	Left	16"	16"	16"
CPR2	1	Right	16"	16"	16"
CPR31	3	Left	16"	16"	16"
CPR32	3	Right	16"	16"	16"

* Outside Dimensions

SPECIFICATIONS:

Materials: Aluminum Extrusion; Clear Acrylic or Clear Lexgard; Plywood; Fiberglass

Finish: Satin Anodized Aluminum

Glazing: 1-1/4" Level 1 Acrylic; 1-1/4" Level 3 Lexgard

Instructions Included

PROTECTION LEVEL

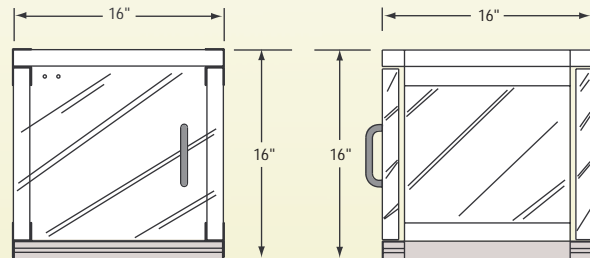

Front or Back View

Side View